

# Map to Loma Ridge Facility

## Emergency Management Bureau

2644 Santiago Canyon Road · Silverado · CA 92676-9719

Office Phone: (714) 628-7055

Going east on Chapman Avenue, as you cross over Jamboree, the street name changes to Santiago Canyon Road. Continue on Santiago Canyon Road crossing over the toll roads, passing all **“on” and “off” ramps** for toll roads. Just as you pass the last signal for the 241 **“off” ramp**, the road narrows and you will see a sign that says “right lane must turn right”, get into that lane. This is the EOC Road Bridge. Turn right going **over** the 241 toll road. At the end of the bridge you will see a sign that says “Private Road No Public Access”. Continue to the left around the mountain to the call box at gate. **The distance from Jamboree to the EOC Road Bridge is approximately 2 miles. All visitors, unless otherwise instructed, must park in lower parking lot.**

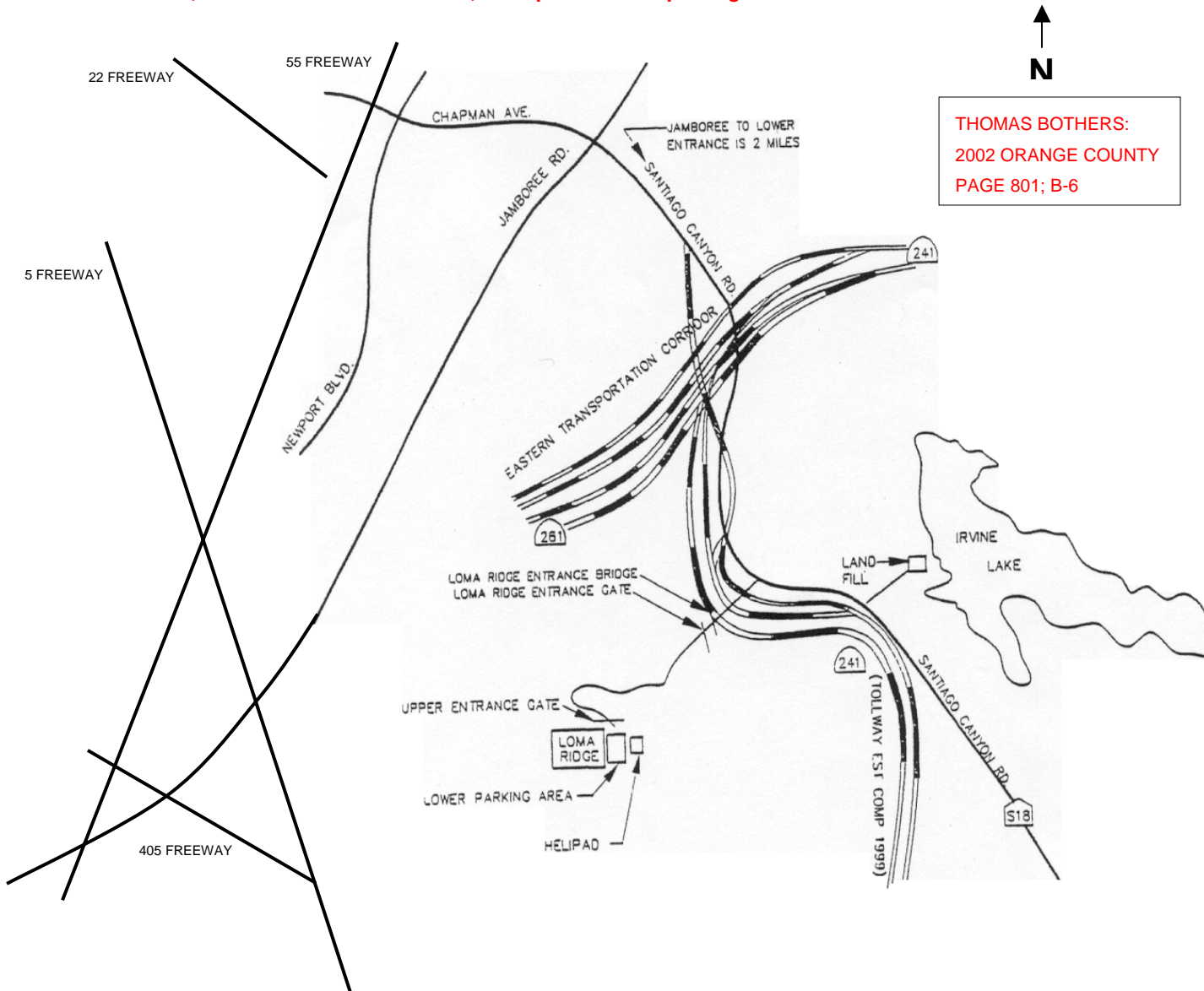

### PLEASE NOTE:

The road to Loma Ridge Facility is narrow. Watch for opposing traffic.  
Use caution and control vehicle speed.